



PROPERTY OVERVIEW

Located 1/2 mile north of the Virginia Beach Central Business District, Jericho Plaza is a neighborhood professional center ideal for prime office/service and retail shops.

- Located on Independence Boulevard, a major north/south artery
- Excellent visibility at the intersection of Independence Boulevard and Jericho Road
- Close access to I-264/64
- **FULLY LEASED**

DEMOGRAPHICS

Radius:	1 mile	3 mile	5 mile
Population:	14,155	113,337	267,415
Average HH Income:	\$52,880	\$55,955	\$57,818
Traffic Count:	±57,000 VPD		

AREA MAP

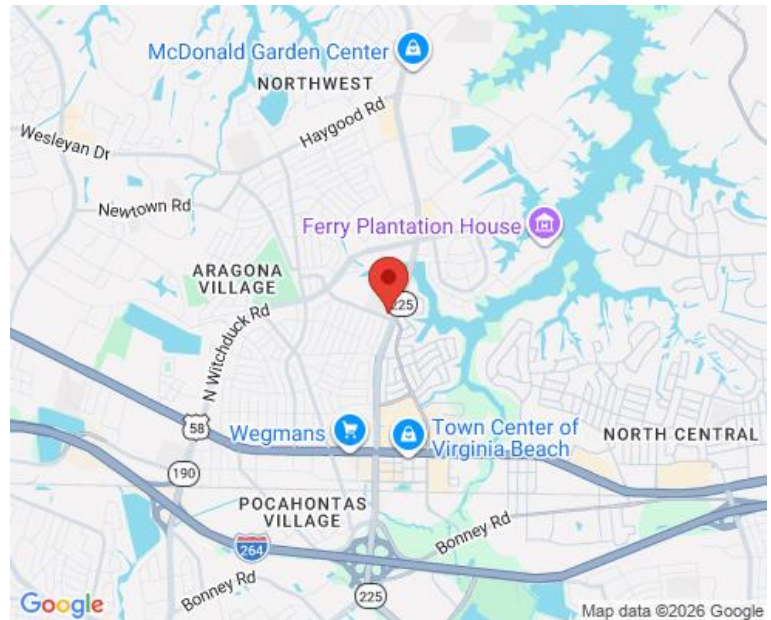

FOR MORE INFORMATION, PLEASE CONTACT:

LENNY BURNS
 (757) 490-3141
lburns@pembrokerealty.com

Pembroke Realty Group
 4433 Corporation Lane, Suite 250
 Virginia Beach, VA 23462
www.pembrokerealty.com

633 Independence Boulevard

± 0 SF AVAILABLE



FOR MORE INFORMATION, PLEASE CONTACT:

LENNY BURNS

(757) 490-3141

lburns@pembrokerealty.com

Pembroke Realty Group

4433 Corporation Lane, Suite 250

Virginia Beach, VA 23462

www.pembrokerealty.com

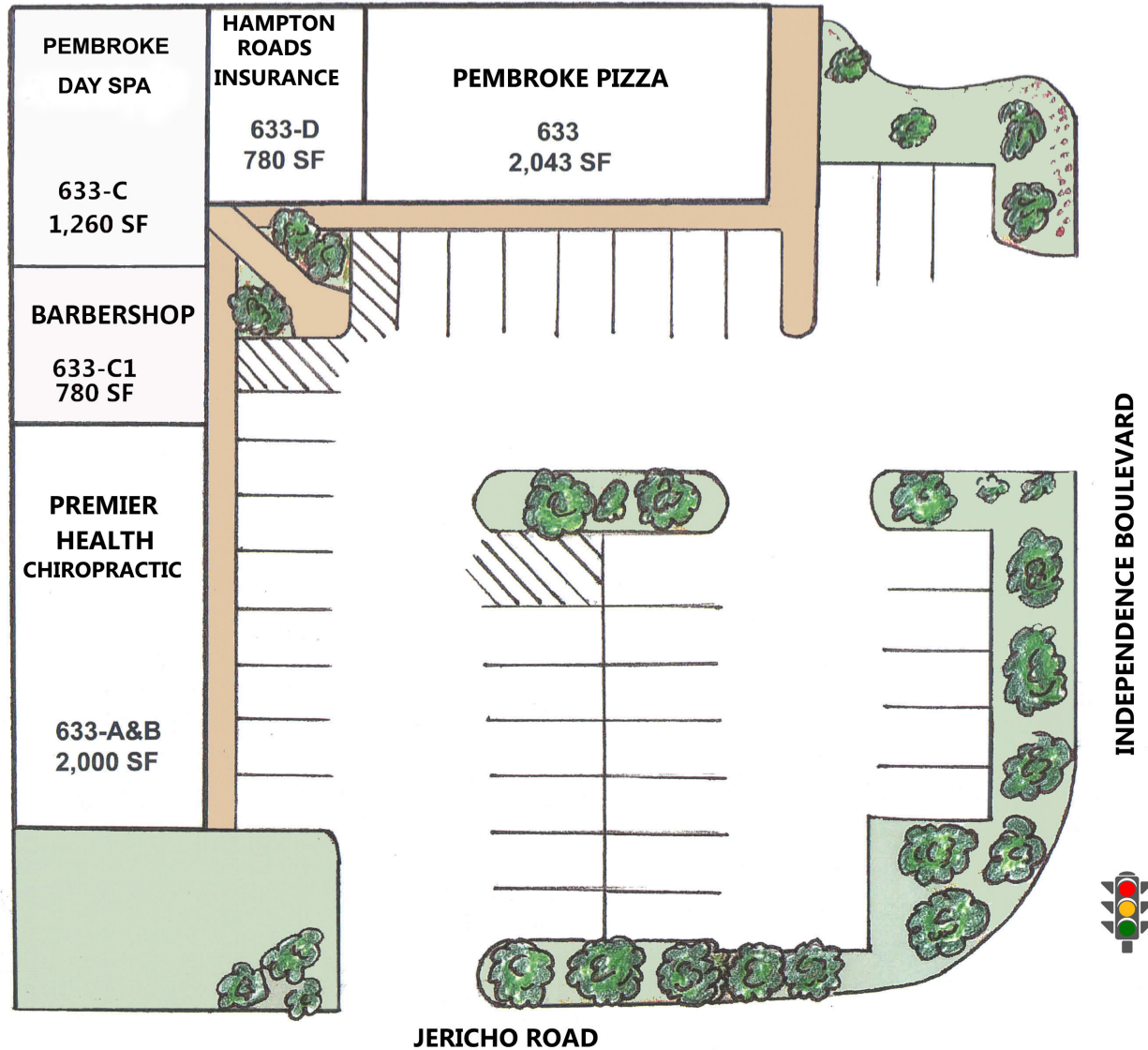

FOR MORE INFORMATION, PLEASE CONTACT:

LENNY BURNS
(757) 490-3141
lburns@pembrokerealty.com

Pembroke Realty Group
4433 Corporation Lane, Suite 250
Virginia Beach, VA 23462
www.pembrokerealty.com