



PROPERTY OVERVIEW

Sewells Point Place is a 4,841 SF retail strip center located at the intersection of Sewells Point Road and Avenue J, just off of E. Little Creek Road. Close proximity to Super Walmart on Tidewater Drive.

- Conveniently located off E. Little Creek Road, which has a traffic count of 26,000 VPD
- Parking -- 26 spaces
- **FULLY LEASED**

AREA MAP

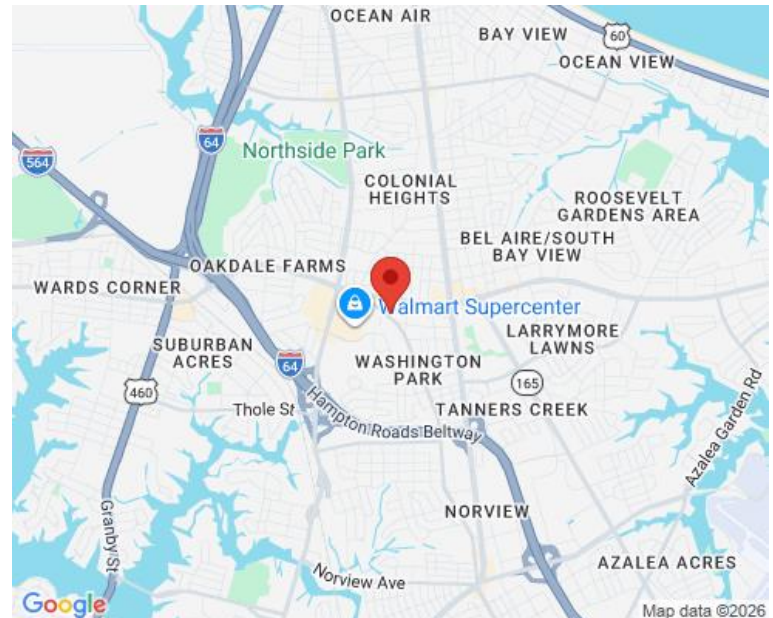

DEMOGRAPHICS

Radius:	1 mile	3 mile	5 mile
Population:	17,872	115,980	239,152
Average HH Income:	\$50,537	\$62,841	\$64,227
Traffic Count:	26,000		

FOR MORE INFORMATION, PLEASE CONTACT:

LENNY BURNS
(757) 490-3141
lburns@pembrokerealty.com

Pembroke Realty Group
4433 Corporation Lane, Suite 250
Virginia Beach, VA 23462
www.pembrokerealty.com

SEWELLS POINT PLACE

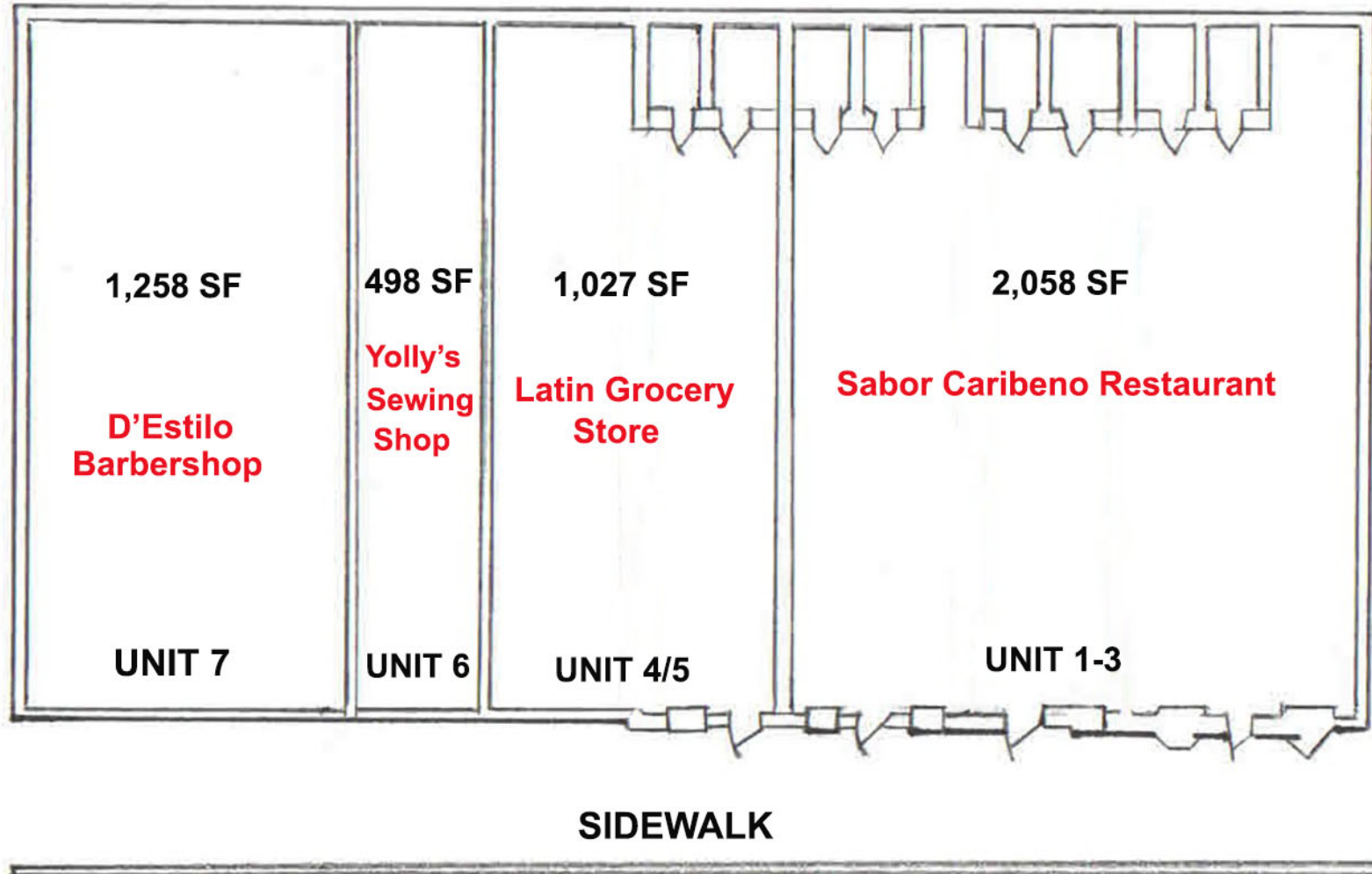

FOR MORE INFORMATION, PLEASE CONTACT:

LENNY BURNS
(757) 490-3141
lburns@pembrokerealty.com

Pembroke Realty Group
4433 Corporation Lane, Suite 250
Virginia Beach, VA 23462
www.pembrokerealty.com

7616 Sewells Point Road

± 0 SF AVAILABLE



FOR MORE INFORMATION, PLEASE CONTACT:

LENNY BURNS

(757) 490-3141

lburns@pembrokerealty.com

Pembroke Realty Group

4433 Corporation Lane, Suite 250

Virginia Beach, VA 23462

www.pembrokerealty.com